

RHINO VALVES WORLDWIDE

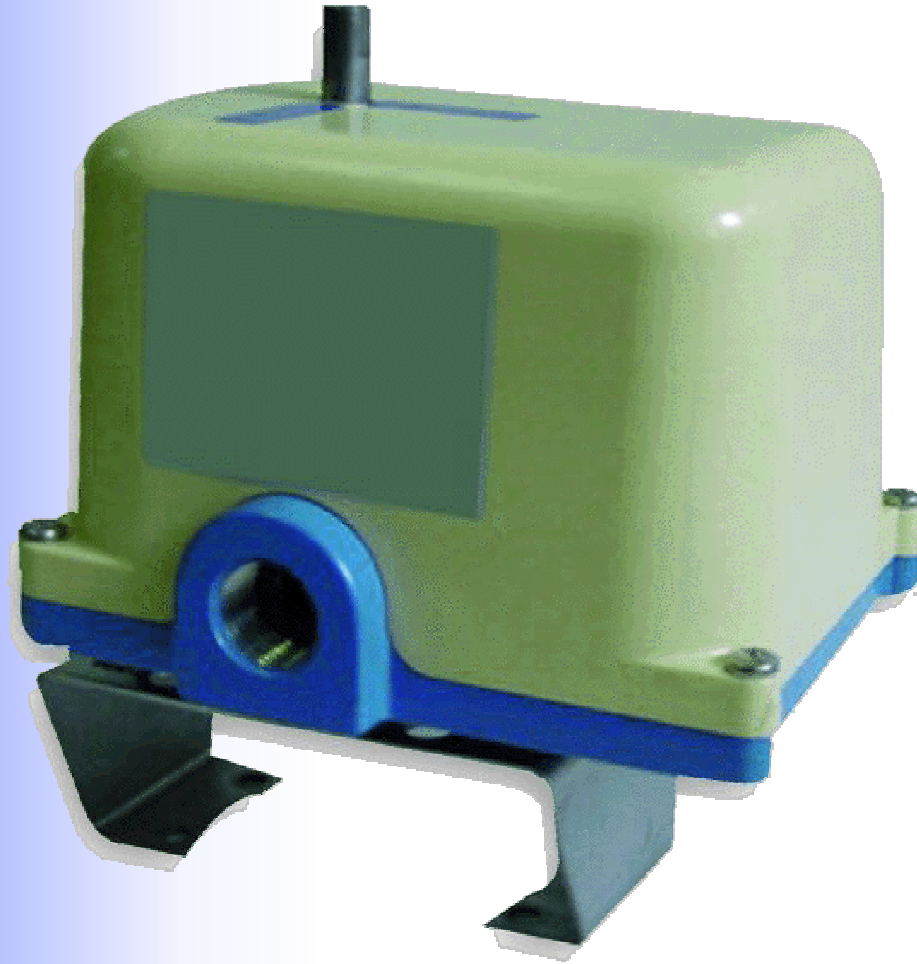

Electric Actuators



LICENSE No. 6D-0321

**The best in their type.
Great exit torque,
silent and reliable.
Available in different configurations.**



RHINO VALVES WORLDWIDE



ELECTRIC ACTUATORS

We can offer you a wide range of high performance Electric Actuators and its accessories and options.
Please consult with your distributor or our factory according with your needs.



ELECTRIC ACTUATOR MODEL LCR

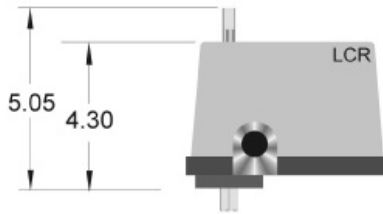

ELECTRIC ACTUATOR MODEL LVWX

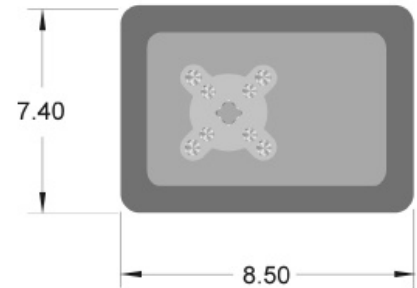
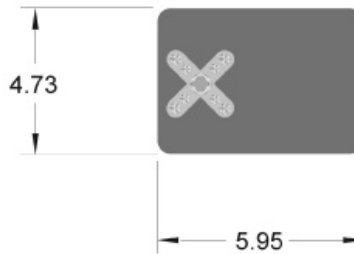
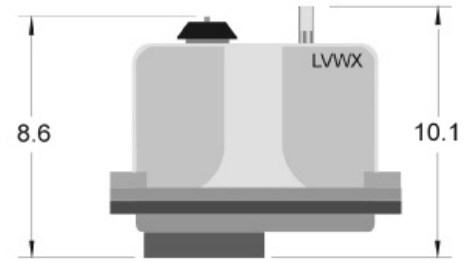

Voltage: 115 VAC / 230 VAC / 24 VAC
Exit : 150 at 600 in lbs
Limit of temperature: -40° F to 150° F (with heater and thermostat)
Connection: conduit ½"14 NPT.
Cover: PVC, composite
Base : Zinc Alloy
Finish : powder epoxy
Classification : NEMA 4, 4x
Manual -s-clutch : Standard
Options : Timer, D-180 degrees, additional Switches limit, heater and thermostat, position indicator.

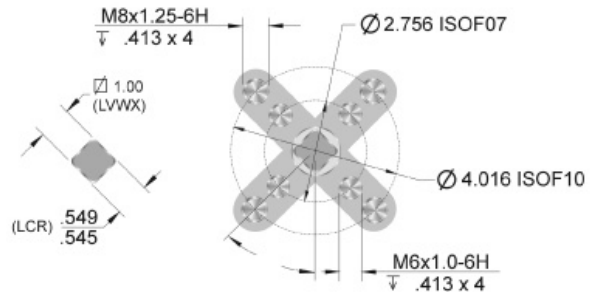

MODEL	TORQUE lb/in	VOLTAGE	CYCLE OF SERVICE	SPEED	115 VAC	WEIGHT APPROXIMATE
LCR-150	150	115	25%	5	0.5	6.018 Lb.
LCR-300	300	115	25%	8	0.5	6.018 Lb.
LCR-600	600	115	25%	13	0.5	6.018 Lb.
LVWX1500	1500	115	75%	15	0.8	14.109 Lb.
LVWX3000	3000	115	55%	30	0.8	14.109 Lb.