

STAINLESS STEEL BALL VALVE

3-PIECE DESIGN FULL BORE

SIZE RANGE 10mm-50mm

ANSI 316

Suitable for domestic and commercial plumbing, Industrial Applications, Oil Pipelines, Hot Water Services, Condensate Lines, Water Treatment, HVAC, Mining and W.W.T.P. Applications



FEATURES

- Full bore
- ISO 5211 mounting pad
- Blow-out proof system
- Stainless steel components

OPTIONS

- Pneumatic actuators
- Electric actuators
- Butt weld ends

Fig. V3MH

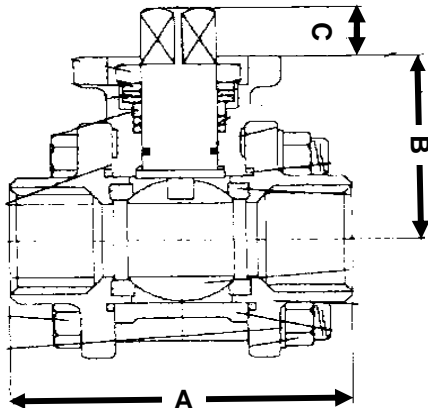

COMPONENT	MATERIAL
BODY	STAINLESS STEEL - CF8M
BALL	STAINLESS STEEL - CF8M
BALL SEAT	15% R-P.T.F.E.
JOINT GASKET	15% R-P.T.F.E.
O-RING	VITON
STEM	AISI 316

DIMENSIONS

SIZE mm	8	10	15	20	25	32	40	50
A	58	58	62	77	83	94	107	120
B	36.0	36.0	38.0	41.7	44.4	52.8	58.5	66.0
C	9.6	9.6	9.6	11.6	11.6	11.2	11.2	11.2
MAX kPa @ 50°C	10,300	10,300	10,300	10,300	9,600	9,600	9,600	9,600
ISO 5211	F03	F03	F03	F03	F04/F05	F05/F07	F05/F07	F05/F07
TORQUE Nm	4.0	4.0	5.4	7.4	10.4	13.5	18.0	25.0
BORE Ø	11.6	12.8	15.0	20.0	25.0	32.0	38.0	50.0
CV	6.6	7.9	11.2	21.0	34.0	57.0	80.0	148.0

Data Sheet No. BL-V3MH-Rev02

For installation, operation and maintenance refer to I.O.M.

Details subject to change

Global Valves and Engineering Pty Ltd

“your partner for the future”

Tel: (02) 9868 5055 Fax: (02) 9868 5063 Email: sales@globalvalves.com.au Website: www.globalvalves.com.au

STAINLESS STEEL BALL VALVE

3-PIECE DESIGN FULL BORE

SIZE RANGE 10mm-50mm

ANSI 316

Suitable for domestic and commercial plumbing, Industrial Applications, Oil Pipelines, Hot Water Services, Condensate Lines, Water Treatment, HVAC, Mining and W.W.T.P. Applications



FEATURES

- Full bore
- ISO 5211 mounting pad
- Blow-out proof system
- Stainless steel components

OPTIONS

- Pneumatic actuators
- Electric actuators
- Butt weld ends

Fig. V3MH

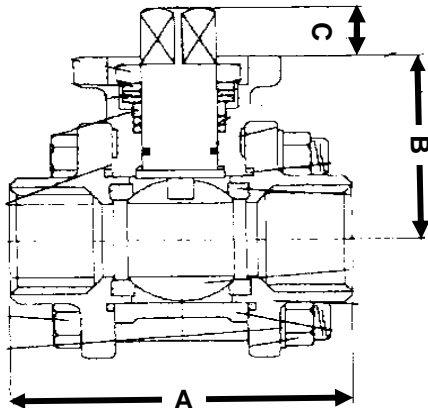

COMPONENT	MATERIAL
BODY	STAINLESS STEEL - CF8M
BALL	STAINLESS STEEL - CF8M
BALL SEAT	15% R-P.T.F.E.
JOINT GASKET	15% R-P.T.F.E.
O-RING	VITON
STEM	AISI 316

DIMENSIONS

SIZE mm	8	10	15	20	25	32	40	50
A	58	58	62	77	83	94	107	120
B	36.0	36.0	38.0	41.7	44.4	52.8	58.5	66.0
C	9.6	9.6	9.6	11.6	11.6	11.2	11.2	11.2
MAX kPa @ 50°C	10,300	10,300	10,300	10,300	9,600	9,600	9,600	9,600
ISO 5211	F03	F03	F03	F03	F04/F05	F05/F07	F05/F07	F05/F07
TORQUE Nm	4.0	4.0	5.4	7.4	10.4	13.5	18.0	25.0
BORE Ø	11.6	12.8	15.0	20.0	25.0	32.0	38.0	50.0
CV	6.6	7.9	11.2	21.0	34.0	57.0	80.0	148.0

Data Sheet No. BL-V3MH-Rev02

For installation, operation and maintenance refer to I.O.M.

Details subject to change

Global Valves and Engineering Pty Ltd

“your partner for the future”

Tel: (02) 9868 5055 Fax: (02) 9868 5063 Email: sales@globalvalves.com.au Website: www.globalvalves.com.au