

BRASS PRESSURE REDUCING

25 BAR RATED

SIZE RANGE 15mm-50mm

Male Union Ends

Suitable for pressure reducing applications in Water, Air and Neutral Gases up to 70 Deg C in Sewerage and Water Treatment, Pulp & Paper, Power Generation, HVAC, Mining and other General Industries



FEATURES

- Outlet pressure 100 - 600 kPa
- Suitable for use up to 70 Deg C
- Union connection for ease of installation
- Built-in stainless steel strainer
- Stable outlet pressure despite inlet fluctuations
- Low noise level < 20 decibels
- Quality assurance to ISO 9001

OPTIONS

- Fig. DRV/PG with pressure gauge
- Fig. DRV/E low flow

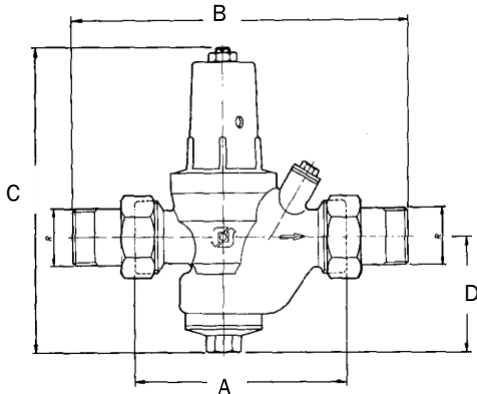
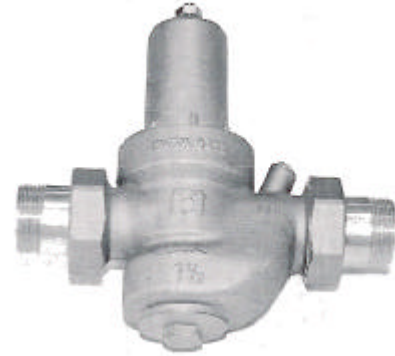

Fig. DRV



COMPONENT MATERIAL

COMPONENT	MATERIAL
BODY	BRASS
UNIONS	BRASS
SEAT	BRASS
STRAINER MESH	STAINLESS STEEL
BODY FINISH	SHOT BLAST

DIMENSIONS

SIZE mm	15	20	25	32	40	50
A	97	110	120	140	160	175
B	152	171	191	211	246	261
C	135	155	182	227	255	262
D	47.5	57.5	66	75	82	88
FLOW RATE (L/min) @ PRESSURE DROP kPa	4 30	5 30	8 30	10 30	18 30	21 30

Data Sheet No. PR-DRV-Rev01

For installation, operation and maintenance refer to I.O.M.

Details subject to change

Global Valves and Engineering Pty Ltd

"your partner for the future"

Tel: (02) 9868 5055 Fax: (02) 9868 5063 Email: sales@globalvalves.com.au Website: www.globalvalves.com.au