

# STAINLESS STEEL BALL VALVE

## 1-PIECE REDUCED BORE

### SIZE RANGE 8mm-50mm

### BSP Ends



Suitable for Isolating duties in General Industrial Applications, Oil Pipelines, Hot Water Services, Condensate Lines, Water Treatment, HVAC, Mining, W.W.T.P. Applications, Gauge and Instrument Isolation

### FEATURES

- Drip tight shut off
- PVC lever grip
- Compact, one piece design
- ISO 9001 approved manufacturer
- Stainless steel components

### OPTIONS

- Fig. V1-WCB (WCB steel body)
- Fig. V1-NPT (with NPT ends)
- Fig. V3 (3 piece full bore)

Fig. V1

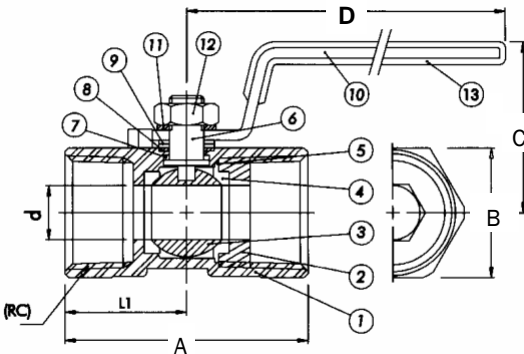

COMPONENT	MATERIAL
BODY	STAINLESS STEEL - CF8M
BALL	STAINLESS STEEL - CF8M
SEAT	P.T.F.E.
STEM SEAL	P.T.F.E.
LEVER	STAINLESS STEEL - 304

### DIMENSIONS

SIZE mm	8	10	15	20	25	32	40	50
A	39	44	56.5	59	71	78	82	100
B	17	21	25	32	38	48	53	64
C	27	29	45	46	47	54	63	71
D	70	81	96	96	101	101	144	144
MAX kPa @ 38°C	6,900	6,900	6,900	6,900	6,900	6,900	6,900	6,900
MAX kPa @ 150°C	3,450	3,450	3,450	3,450	3,450	3,450	3,450	3,450
BORE $\varnothing$	5	7.2	9.2	12.5	15	20	25	32
CV	3.8	4	4.5	9	16	24	37	68

Data Sheet BL-V1-Rev01

For installation, operation and maintenance refer to I.O.M.

Details subject to change

**Global Valves and Engineering Pty Ltd**

*"your partner for the future"*

Tel: (02) 9868 5055 Fax: (02) 9868 5063 Email: sales@globalvalves.com.au Website: www.globalvalves.com.au